

LU SERIES - GRADE 2 COMMERCIAL DEADBOLT

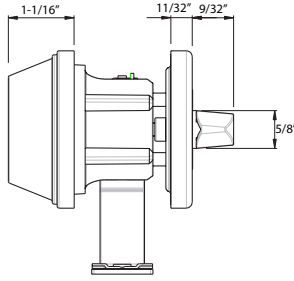

DIMENSIONS

LU - SINGLE CYLINDER (200)



LU - DOUBLE CYLINDER (210)

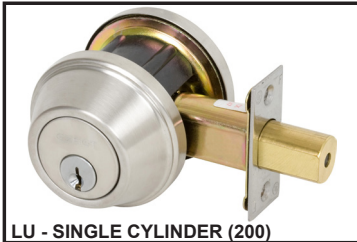
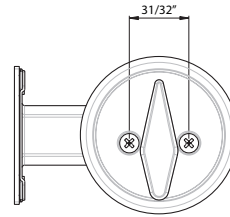
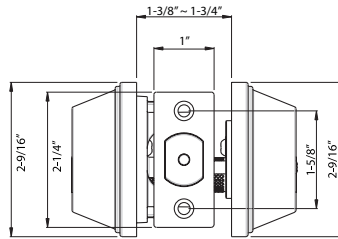
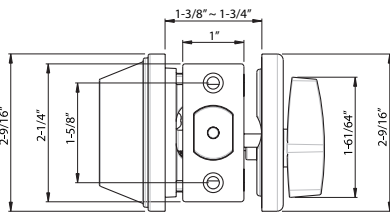
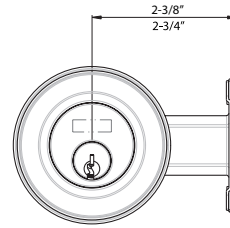
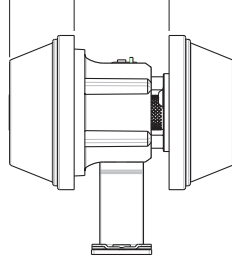

LU - SINGLE CYLINDER (200)

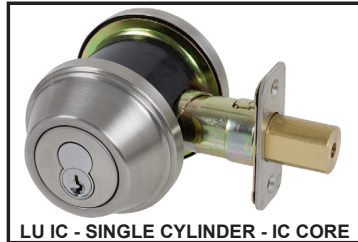

LU IC - SINGLE CYLINDER - IC CORE



STANDARD SPECIFICATIONS

Door Prep	Cross bore: 2-1/8" Edge bore: 1" Latch face: 1" x 2-1/4"	Latches	Deadbolt: 2-3/8" & 2-3/4" adjustable (9091 UL) Faceplate: 1" x 2-1/4" square corner Bolt: Full 1" throw. 3-Hr. Fire Rating
Backset	Fits 2-3/8" and 2-3/4"	Strikes	1-1/8" x 2-3/4" (9111). Includes reinforcement plate
Door Thickness	1-3/8" ~ 1-3/4" door standard	Door Handing	Not Required
Cylinder	SC4 6-pin standard. KW1 5-pin optional Deadbolts packed KA2	Screws	Combination screws that suit both wood or metal door mounting Includes 3" Security Screws
Interchangeable Core	Optional small-format 6-pin or 7-pin available	Product Features	<ul style="list-style-type: none"> Protection Sleeve Free Spinning Cylinder Collar Hardened Steel Rod Latch Insert

ITEM DETAILS

Model	Function	WT/LB	CTN QTY	US32D Stainless Steel	US3 Polished Brass	US26D Dull Chrome	US10B Oil Rubbed Bronze
200-LU	Single Cylinder	21 Lbs	20 Pcs	Item No. 300601	300603	300602	300610
210 LU	Double Cylinder	34 Lbs	20 Pcs	Item No. 320601	320603	—	320610
200 RC Removable Core	Single Cylinder Removable Core (Core not Included)	41 Lbs	20 Pcs	Item No. 300600A	—	—	—
Core Only	6-Pin SFIC Core Only	5 Lbs	10 Pcs	Item No. 300600C	—	—	—
Core Only	7-Pin SFIC Core Only	5 Lbs	10 Pcs	Item No. 300600D	—	—	—



DELANEY

Copyright © DELANEY HARDWARE. All rights reserved.